

Wall Storage unit Type WA-M



GESCHA Wall Storage unit Type WA-M

With the WA-M, GESCHA offers a mounted unit for drying and storage. The single tier distances can be changed fast and easy with the **GESCHA WikiWiki plug in system** according to your needs.

To assure perfect setting for each type of use, the tilt of each rack is individually adjustable. WA-M can be folded away after use to save space.

The advantages of the wall storage unit are:

- **Single setting of each shelf rest**
- Surface protection through coated shelf rests (solvent free)
- Standard equipment: 9 shelf rests
- Expandable with additional shelf rests to 17 tiers
- More storage depth through shelf rests with extension rods to the front
- Quick and easy to change with GESCHA WikiWiki System.

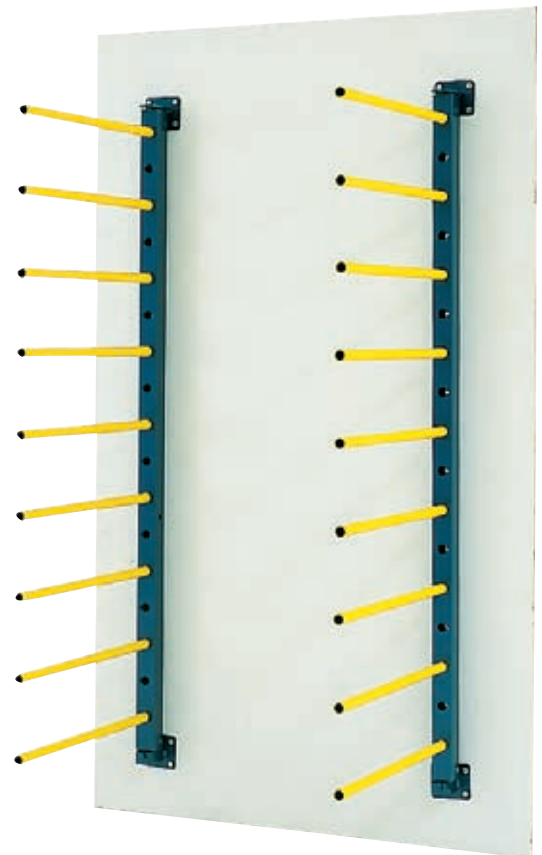

GESCHA Wall Storage unit Type WA-M 2 racks.
You can mount additional wall storage units.

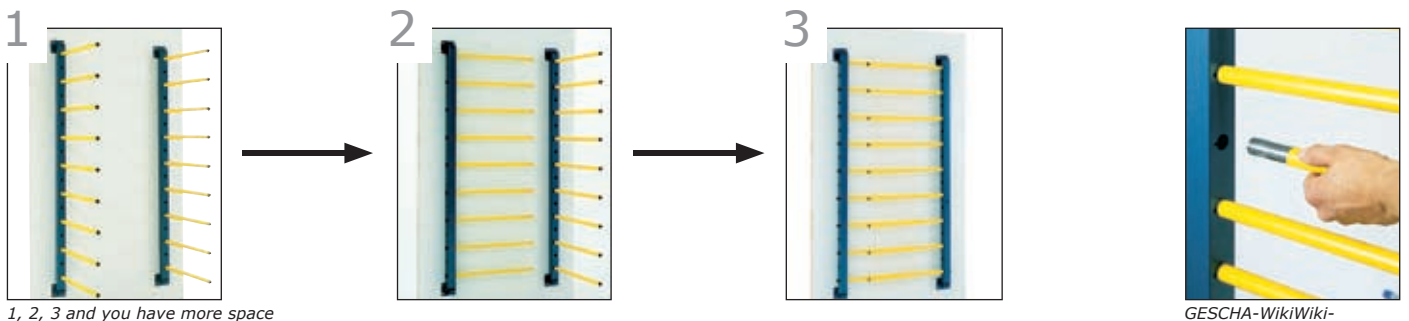

1, 2, 3 and you have more space

GESCHA-WikiWiki-Plug in system

Wall Storage Unit WA-M							
Type/ Art.-No.	Usable length (mm)	Max. load/ Pair (kg)	Max. total Weight (kg)	Max. bars	bars	Tiers Clearance (mm)	Rod Ø (mm)
		at evenly distributed weight without impact loading					
WA-M*/ 21738	600 - 900	40-50	140	17	9	70	24
Addition Shelf rests 8 pcs/ 21753	600 - 900	-	-	-	+8	-	-

*Per unit at least to racks necessary

Best possible painting results

